

○ END CONDITION DETAIL

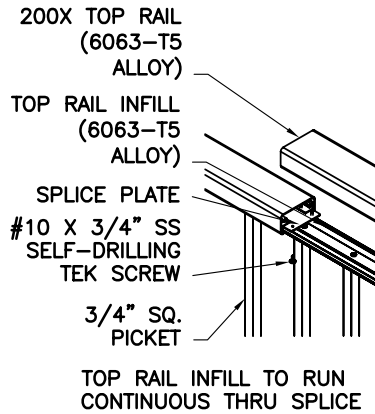

○ SPLICE PLATE DETAIL

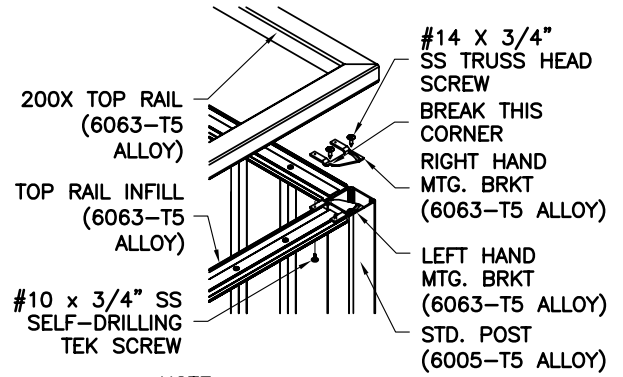

NOTE:
 FOR 90° MITERS, BREAK OFF CORNERS OF BRACKETS AND PLACE AS SHOWN

○ TYP. CORNER CONN.

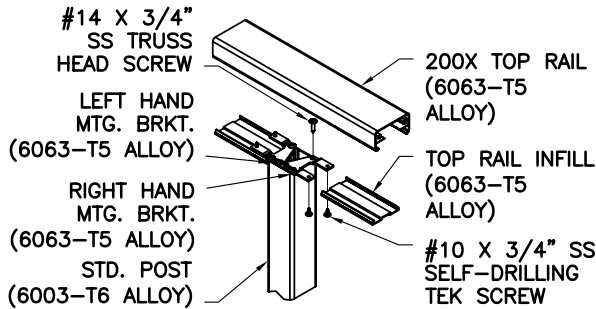
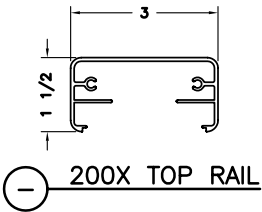

○ TYP. TOP RAIL CONNECTION

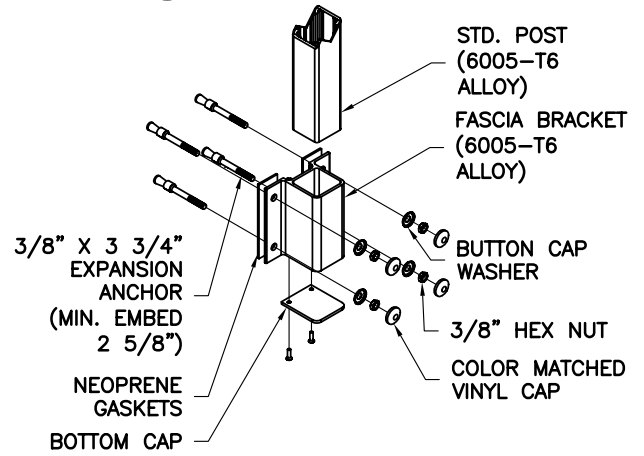

○ FASCIA MOUNTING DETAIL

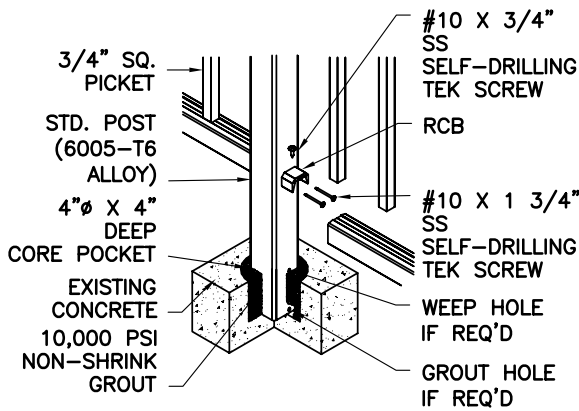
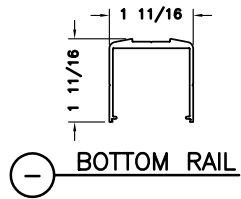

○ POST ONLY CORE POCKET DETAIL

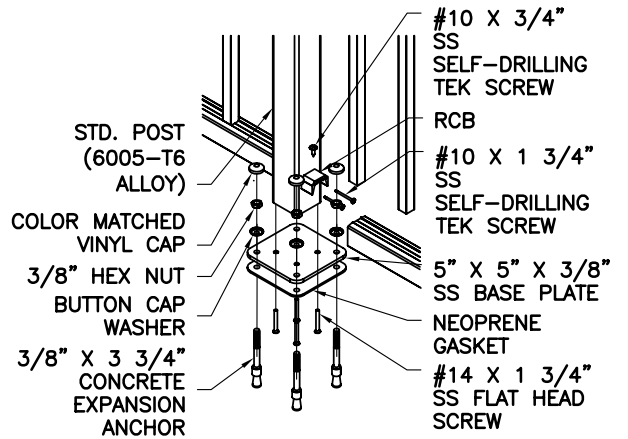

○ SURFACE MOUNTING DETAIL

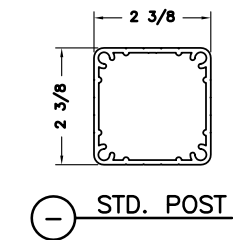

SERIES 200X PICKET RAILING SYSTEM

THE INFORMATION CONTAINED IN THIS DRAWING IS THE SOLE PROPERTY OF HANSEN ARCHITECTURAL SYSTEMS, INC. ANY REPRODUCTION IN PART OR AS A WHOLE WITHOUT THE WRITTEN PERMISSION OF HANSEN ARCHITECTURAL SYSTEMS, INC. IS PROHIBITED.

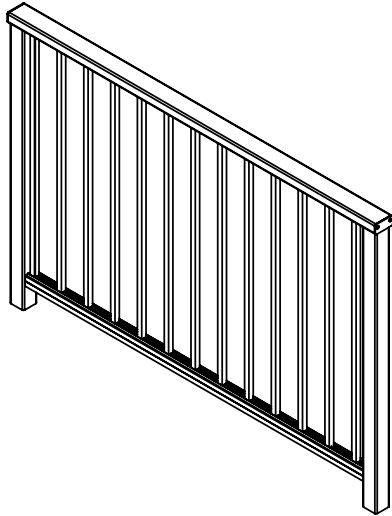

① TYPICAL ISOMETRIC

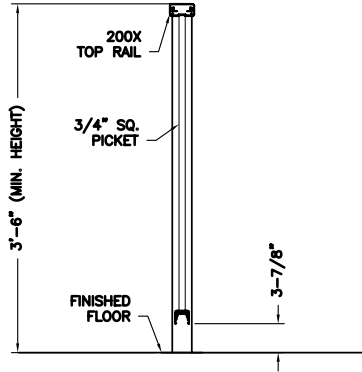

① TYPICAL SECTION

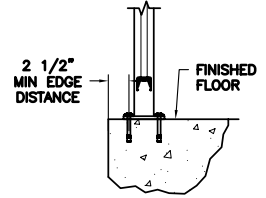

① SURFACE MOUNT

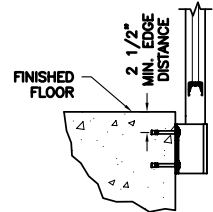

① FASCIA MOUNT

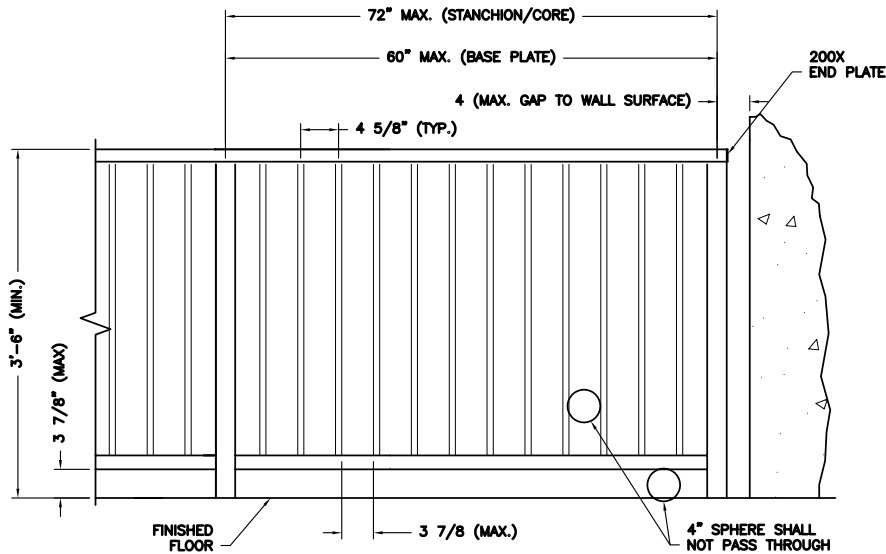

① TYPICAL ELEVATION

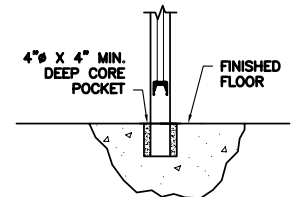

① CORE MOUNT

SERIES 200X PICKET RAILING SYSTEM

THE INFORMATION CONTAINED IN THIS DRAWING IS THE SOLE PROPERTY OF HANSEN ARCHITECTURAL SYSTEMS, INC. ANY REPRODUCTION IN PART OR AS A WHOLE WITHOUT THE WRITTEN PERMISSION OF HANSEN ARCHITECTURAL SYSTEMS, INC. IS PROHIBITED.